

YKWL1005C

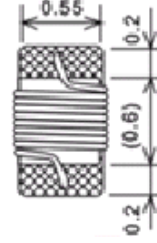
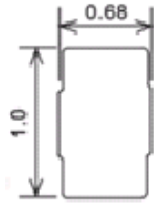

特征:

- 细小和轻型
- 具有优良的焊接和耐热能力。适用于波峰焊及回流焊接
- 标准尺寸，可靠度高，能适应高速表面装配。
- 阻止电磁波干扰产品内的其他部件
- 应用于电讯产品、移动电话、传呼机、电脑、数据机、电器用品、电视、录像机。

FEATURES:

- Small and light weight.
- Excellent solder ability and resistance to soldering
- Heat suitable for flow and reflow soldering.
- Good dimension ,high reliability and high speed surface mount assembly
- prevention of electro magnetic interference to signals on the secondary side of electric equipment
- Widely use in tele communication products, phones mobile, pagers, computers, modems, OA products, TVs, VCRs, etc.

Inductance Range/电感范围: 1.0nH~120nH.

Temperature Range/使用温度: -30℃~100℃.

Electrical Characteristics/电气特性

Part No 名称	Inductance 电感(nH)	Min. Quality Factor 品质因子	L/Q Test Freq 测试频率(MHz)	DC Resutance 直流电阻 Max (Ω)	Rated Current 额定电流 (mA)	Min. Self-resonant Frequency 自谐振频率
YKWL1005C1N0□	1.0	13	250	0.039	1000	>6000
YKWL1005C2N2□	2.2	16	250	0.073	840	>6000
YKWL1005C3N9□	3.9	17	250	0.110	800	5800
YKWL1005C4N7□	4.7	20	250	0.110	800	5800
YKWL1005C6N8□	6.8	23	250	0.142	680	4400
YKWL1005C8N2□	8.2	24	250	0.142	680	4400
YKWL1005C10N□	10	25	250	0.177	600	3700
YKWL1005C15N□	15	26	250	0.208	560	3200
YKWL1005C18N□	18	26	250	0.245	480	3000
YKWL1005C20N□	20	26	250	0.245	480	3000
YKWL1005C27N□	27	26	250	0.362	375	2700
YKWL1005C33N□	33	26	250	0.408	320	2200
YKWL1005C47N□	47	26	250	0.546	260	2000
YKWL1005C56N□	56	26	250	0.741	200	1900
YKWL1005C68N□	68	26	250	1.160	190	1800
YKWL1005C82N□	82	26	250	1.330	180	1700
YKWL1005CR10□	100	26	250	1.870	160	1300
YKWL1005CR12□	120	26	250	2.350	140	1200

Sans Plomb (SGS Certified Result) 本产品满足环境保护要求(有害物质限用)					
pb 铅	Cd 镉	Cd 汞	六价铬 Cr+6	多溴联苯 PBBs	多溴联醚 PBDEs
<1000PPm	Nd	Nd	Nd	Nd	Nd

- 1、Inductance is measured with a LCR meter: Agilent 4287 or equivalent. Test frequency at 250 MHz.
 - 2、DC resistance is measured with a Digital Multimeter VR1153 LCR+DCR or equivalent.
 - 3、The DC Bias test with VR1153 & VR7210, The maximum allowable current is a DC current which causes initial inductance to decrease by 25%. or temperature to rise by 40℃, whichever is smaller. (At ambient reference temperature: 20℃).
- 1、电感值测试仪: Agilent 4287 或同等 LCR Meter. 测试频率 250MHz.
 - 2、直流电阻测试仪: VR1153 LCR+DCR 或同等的 DCR 测试设备。
 - 3、最大容许电流测试: VR1153 & VR7210; 最大容许电流定义: 电感下降 25% 或温度上升 40℃ 时取其小值作为最大容许电流。(周围环境温度 20℃)

Packaging/包装方式 10000 PCS/REEL

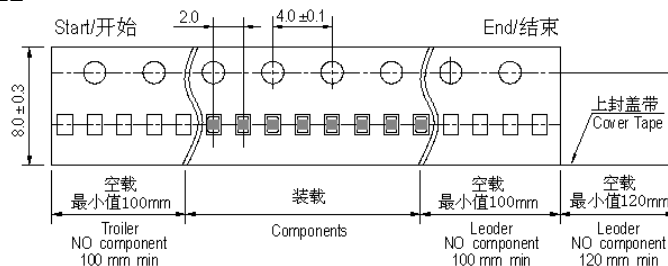

YKWL1608C

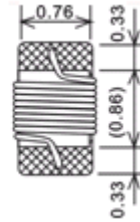
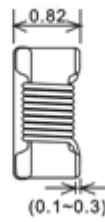
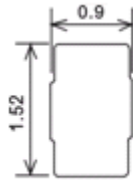

特征:

- 细小和轻型
- 具有优良的焊接和耐热能力。适用于波峰焊及回流焊接
- 标准尺寸，可靠度高，能适应高速表面装配。
- 阻止电磁波干扰产品内的其他部件
- 应用于电讯产品、移动电话、传呼机、电脑、数据机、电器用品、电视、录像机。

FEATURES:

- Small and light weight.
- Excellent solder ability and resistance to soldering
- Heat suitable for flow and reflow soldering.
- Good dimension ,high reliability and high speed surface mount assembly
- prevention of electro magnetic interference to signals on the secondary side of electric equipment
- Widely use in telec ommunication products, phones mobile, pagers,computers,modems,OAproducts,TVs,VCRs,ets.

Inductance Range/电感范围:1.5nH~390nH.

Temperature Range/使用温度: -30℃~100℃.

Electrical Characteristics/电气特性

Part No 名称	Inductance 电感(nH)	Min. Quality Factor 品质因子	L/Q Test Freq 测试频率(MHz)	DC Resutance 直流电阻 Max (Ω)	Rated Current 额定电流 (mA)	Min. Self-resonant Frequency 自谐频率
YKWL1608C1N5□	1.5	16	250	0.045	700	6000
YKWL1608C3N9□	3.9	22	250	0.08	700	6000
YKWL1608C4N3□	4.3	22	250	0.063	700	5900
YKWL1608C6N8□	6.8	27	250	0.11	700	5800
YKWL1608C8N2□	8.2	28	250	0.11	700	4600
YKWL1608C10N□	10	31	250	0.13	700	4800
YKWL1608C15N□	15	35	250	0.17	700	4000
YKWL1608C22N□	22	38	250	0.19	700	3000
YKWL1608C39N□	39	40	250	0.25	600	2200
YKWL1608C47N□	47	38	200	0.28	600	2000
YKWL1608C56N□	56	38	200	0.31	600	1900
YKWL1608C68N□	68	37	200	0.34	600	1700
YKWL1608C82N□	82	34	150	0.54	400	1700
YKWL1608CR10□	100	34	150	0.58	400	1400
YKWL1608CR15□	150	32	150	1.2	200	1300
YKWL1608CR18□	180	25	100	1.35	180	1200
YKWL1608CR22□	220	25	100	1.95	160	1150
YKWL1608CR39□	390	27	100	4.8	120	700

Sans Plomb (SGS Certified Result) 本产品满足环境保护要求(有害物质限用)					
pb 铅	Cd 镉	Cd 汞	六价铬 Cr+6	多溴联苯 PBBs	多溴联醚 PBDEs
<1000PPm	Nd	Nd	Nd	Nd	Nd

- 1、Inductance is measured with a LCR meter: Agilent 4287 or equivalent. Test frequency at 250MHz-100MHz.
 - 2、DC resistance is measured with a Digital Multimeter VR1153 LCR+DCR or equivalent.
 - 3、The DC Bias test with VR1153 & VR7210, The maximum allowable current is a DC current which causes initial inductance to decrease by 25%. or temperature to rise by 40℃, whichever is smaller. (At ambient reference temperature: 20℃).
- 1、电感值测试仪: Agilent 4287 或同等 LCR Meter.测试频率 250MHz-100MHz.
 - 2、直流电阻测试仪: VR1153 LCR+DCR 或同等的 DCR 测试设备。
 - 3、最大容许电流测试: VR1153 & VR7210; 最大容许电流定义: 电感下降 25%或温度上升 40℃时取其小值作为最大容许电流。(周围环境温度 20℃)

Packaging/包装方式 4000 PCS/REEL

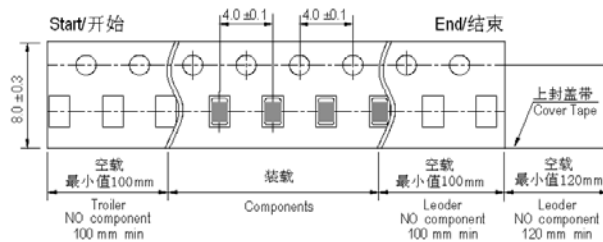

YKWL2012C

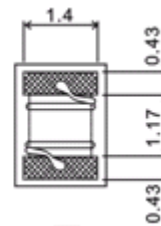
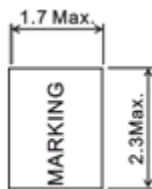

特征:

- 细小和轻型
- 具有优良的焊接和耐热能力。适用于波峰焊及回流焊接
- 标准尺寸，可靠度高，能适应高速表面装配。
- 阻止电磁波干扰产品内的其他部件
- 应用于电讯产品、移动电话、传呼机、电脑、数据机、电器用品、电视、录像机。

FEATURES:

- Small and light weight.
- Excellent solder ability and resistance to soldering
- Heat suitable for flow and reflow soldering.
- Good dimension ,high reliability and high speed surface mount assembly
- prevention of electro magnetic interference to signals on the secondary side of electric equipment
- Widely use in telec ommunication products, phones mobile, pagers,computers,modems,OAproducts,TVs,VCRs,ets.

Inductance Range/电感范围:3.3nH-1000nH.

Temperature Range/使用温度: -30℃~100℃.

Electrical Characteristics/电气特性

Part No 名称	Inductance 电感(nH)	Min. Quality Factor 品质因子	L/Q Test Freq 测试频率(MHz)	DC Resutance 直流电阻 Max (Ω)	Rated Current 额定电流 (mA)	Min. Self-resonant Frequency 自谐频率
YKWL2012C3N3□	3.3	50	200	0.08	600	6000
YKWL2012C6N8□	6.8	50	200	0.11	600	5500
YKWL2012C8N2□	8.2	50	200	0.12	600	4700
YKWL2012C12N□	12	45	200	0.15	600	4000
YKWL2012C15N□	15	45	200	0.17	600	3400
YKWL2012C22N□	22	45	200	0.22	500	2600
YKWL2012C39N□	39	40	200	0.29	500	2000
YKWL2012C47N□	47	40	150	0.31	500	1650
YKWL2012C56N□	56	40	150	0.34	500	1550
YKWL2012C68N□	68	40	150	0.38	500	1450
YKWL2012C82N□	82	40	150	0.42	400	1300
YKWL2012CR10□	100	40	150	0.46	400	1200
YKWL2012CR15□	150	35	100	0.56	400	920
YKWL2012CR27□	270	28	100	1.00	350	650
YKWL2012CR39□	390	23	100	1.50	290	560
YKWL2012CR47□	470	23	50	1.76	250	375
YKWL2012CR56□	560	23	25.2	1.90	230	340
YKWL2012CR68□	680	23	25.2	2.20	190	188
YKWL2012CR82□	820	23	25.2	2.35	180	215
YKWL2012C1R0□	1000	25	25.2	3.20	140	300

Sans Plomb (SGS Certified Result) 本产品满足环境保护要求(有害物质限用)					
pb 铅	Cd 镉	Cd 汞	六价铬 Cr+6	多溴联苯 PBBs	多溴联醚 PBDEs
<1000PPm	Nd	Nd	Nd	Nd	Nd

- 1、Inductance is measured with a LCR meter: Agilent 4287 or equivalent. Test frequency at 200MHz-25.2MHz.
 - 2、DC resistance is measured with a Digital Multimeter VR1153 LCR+DCR or equivalent.
 - 3、The DC Bias test with VR1153 & VR7210, The maximum allowable current is a DC current which causes initial inductance to decrease by 25%. or temperature to rise by 40℃,whichever is smaller. (At ambient reference temperature: 20℃).
- 1、电感值测试仪: Agilent 4287 或同等 LCR Meter.测试频率 200MHz-25.2MHz.
 - 2、直流电阻测试仪: VR1153 LCR+DCR 或同等的 DCR 测试设备。
 - 3、最大容许电流测试: VR1153 & VR7210; 最大容许电流定义: 电感下降 25%或温度上升 40℃时取其小值作为最大容许电流。(周围环境温度 20℃)

Packaging/包装方式 4000 PCS/REEL

